



- ### HARD LANDSCAPE
- Asphalt Roadway**
with 150 concrete kerbs (to Engineers Specification)
Main Drive Road - 4m width
Remaining Road Network - 4.2m width with Flush Kerbs
 - Raised Table**
with 150 concrete kerbs (to Engineers Specification)
Grassy Soft Ramps with 150 Chip Asphalt surfacing on Table
 - Footpath/Rear Garden Paths**
with 150 concrete kerbs (to Engineers Specification)
 - Driveways**
Permeable PC Concrete Paving
e.g. Tobermore Trogus 240x120x60mm
 - Apartment Communal Area**
Permeable PC Concrete Paving
e.g. Tobermore Hydrogrip Trogus 240x120x60mm
 - Rear Garden Terraces**
Permeable PC concrete Paving 400 x 400mm
e.g. Tobermore Trogus 40mm depth
 - Open Space Feature Paving**
Concrete Slab Paving with Decorative Banding
Equipment to detailed design stage
 - Natural Play Spaces (400sq.m)**
Timber Play Equipment with Dark Mahogany surfacing
Equipment to detailed design stage
 - Crèche - Play Surface**
Weibout Safety Surface
 - Bicycle Parking**
Stainless Steel Surfaced Stand Type
 - Concrete Black Wall - Spine Walls**
2.0m high, Reinforced and Capped Colour TBA
(see Detail 03/01 on 1706_PL_DD_01)
 - Steel Bar Fencing** - 1.5m high
Galvanized & Powder Coated - Black
(see Detail 03/01 on 1706_PL_DD_01)
 - Rear Garden Dividing Boundary** - 1.8m high
Timber Panel Fencing with Concrete Posts, Gates to match Fencing
(see Detail 03/01 on 1706_PL_DD_01)
 - Site Boundary Fence** - 1.8m high
Handicapped posts to prevent impact on adjacent trees
(see Detail 03/01 on 1706_PL_DD_01)
 - Site Boundary**
- ### SOFT LANDSCAPE
- Existing Tree to be retained**
(see Tree Survey by Date: 1706_TS_P_01)
 - Existing Earth Bank/Retainer** - to be retained
Removal areas shown on Architectural Impact Drawing
(Drawing Number: 1706_TS_P_02)
Existing vegetation to be selectively pruned & retained with additional native tree/under planting where site impact occurs.
 - Existing Trees to be Removed**
(see Architectural Impact Drawing for details (Drawing Number: 1706_TS_P_02))
 - Proposed Tree Planting:**
 - Street Trees**
180-200 girth, 20m Clear Stem
Alder composite 'Elegant'
Acer platanoides 'Colonnare'
 - Linear Open Space Trees**
180-200 girth
Platanus spacer 'Platan', decidua pendula, Alnus glutinosa, Quercus robur, Sorbus aria
 - Open Space Trees**
180-200 girth
Platanus spacer 'Platan', decidua pendula, Alnus glutinosa, Quercus robur, Sorbus aria
 - Replacement Trees to Northern Boundary**
Semi-mature Common Line Trees (30-35cm girth) planted at 15 metre centres.
 - Amenity Grass with Seasonal Bulbs**
 - Shrub Planting - Public Areas**
Container Grown, P5 - 200
to include the following species:
Lonicera xylosteum, Geranium robertianum, Carex subulmaria, Eranthis, Hypericum 'Redolent', Mahonia aquifolium, Pteris aquilina, Cornus alba, Viburnum chinensis, Prunus laurocerasus
 - Shrub Planting - Front Gardens**
Local Nurseries Planting to include: Prunella & Fum. selection, including planting from the above list of shrubs @ 6 per sq.m.
 - Garden Lawns**
Cultivar Grassland Grass Seed Mix
200mm layer depth
Amenity Grass Lawn
Cultivar Grassland Grass Seed Mix
200mm layer depth
 - New Wood Native Hedgerow** (to be retained)
to include Hawthorn (Crataegus monogyna), Blackthorn (Prunus spinosa), Holly (Ilex aquifolium), Guelder Rose (Viburnum opulus), Common Dogwood (Cornus sanguinea)
 - Grass Mounds**
1m height maximum

NOTES:

- This drawing is intended to show landscape architectural proposals only. Please refer to Architects and Engineer's drawings for relevant details of buildings, structures, roads, parking, etc.
- The copyright of this drawing is vested with Murray & Associates. This drawing may not be copied or reproduced without written consent.
- All materials referred to on this drawing, including plant species, are indicative and subject to change following detailed site investigation. Significant changes, if any are required, will be referred to the relevant authority for agreement.
- This drawing is not suitable for use for construction purposes.
- Discrepancies to be referred to Murray & Associates for clarification.

Rev	Date	Revision	By	DR	JD
0	21-02-19	Planning Issue	MT	JD	

murray & associates
landscape architecture
16 The Scepter Building
44-45 Conifer Road
Glenageary, Dublin 24
© m&a@murray-associates.com | 01 854 0000

Project Title: Creagh Residential Development
Client: Strutec
Sheet Title: Landscape Layout Plan - Sheet 3
Sheet No.: 1706_PL_P_2.3_IJP
Project Architect: Strutec
Date: 21-02-19
Revision: 0
Copyright MURRAY and Associates, 2019

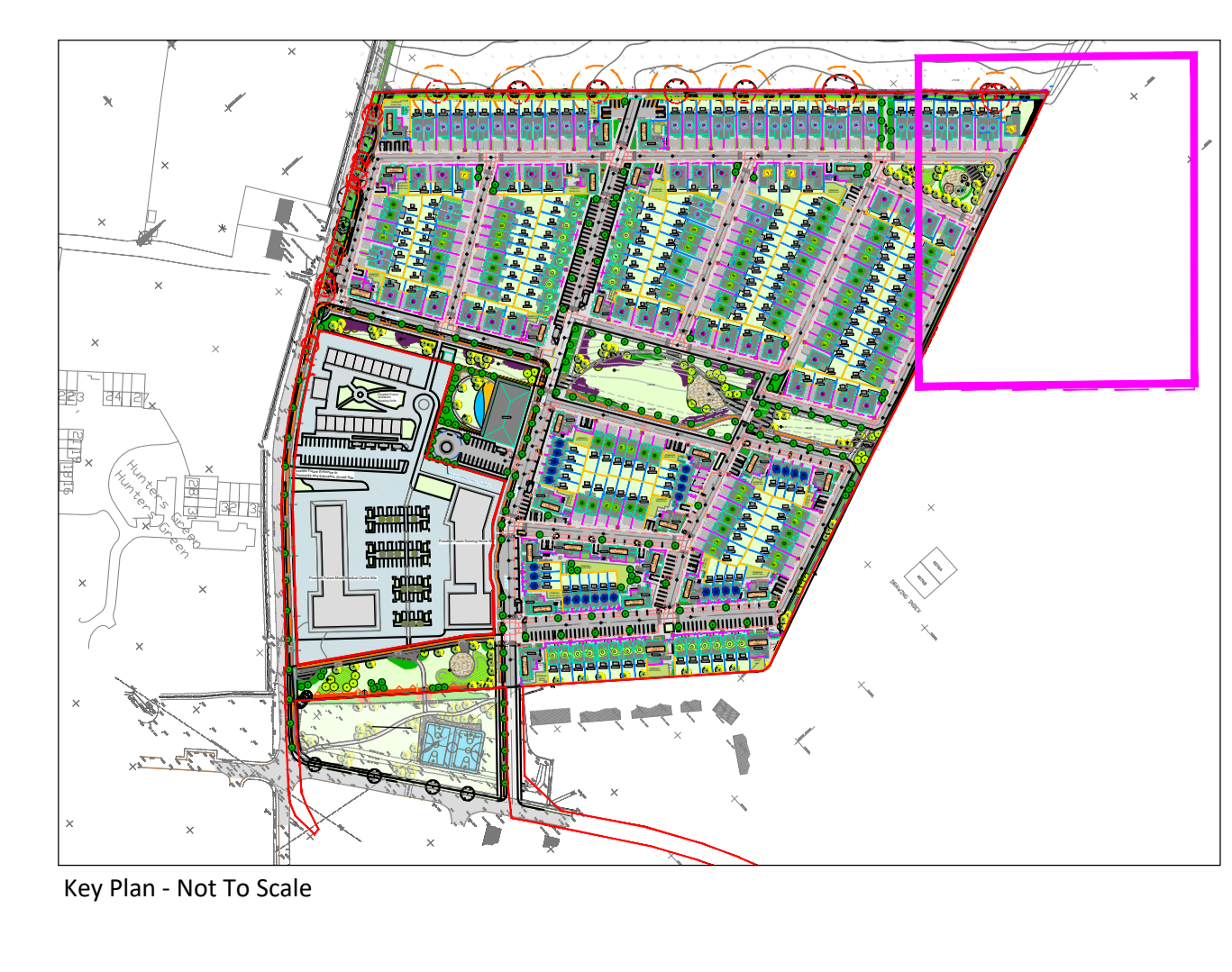

Key Plan - Not To Scale